

LIT
ACCESSORI
ACCESSORIES

06L T901C0 / 06L T902C0 -

1. Installazione - installation:

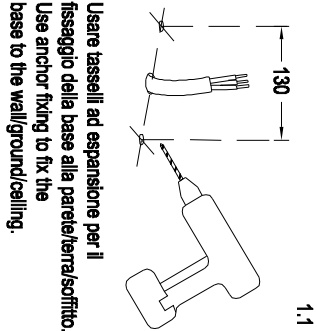
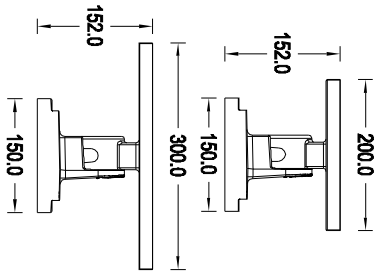

1.1

1.2

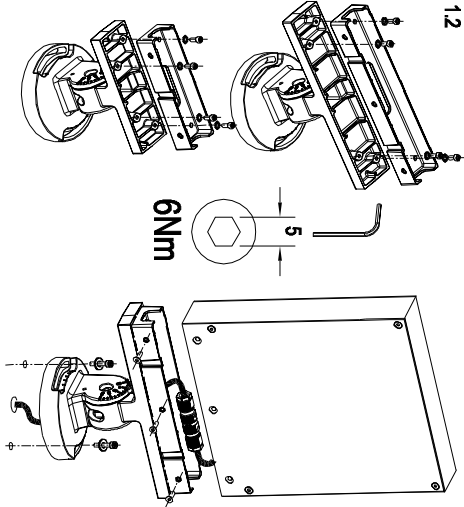

1.3

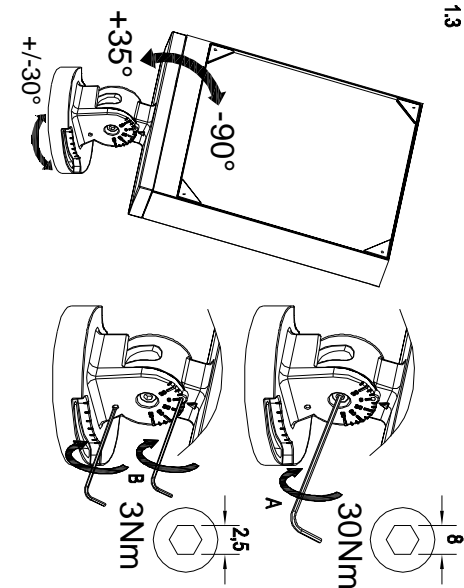

06L T909J0 -

Direzione emissione luminosa
Light emission direction

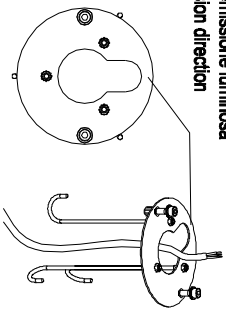

2. Installazione - installation:

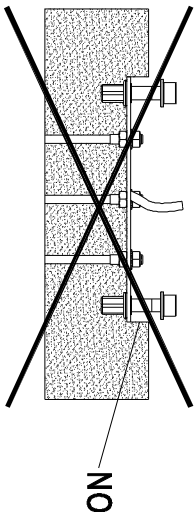
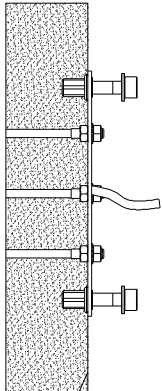

06L T929C0-06L T930C0

06L T912C0-06L T913C0

3. Installazione - installation:

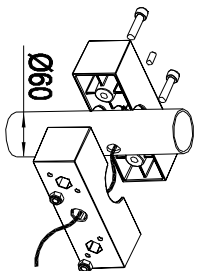

06L T910C0-06L T911C0

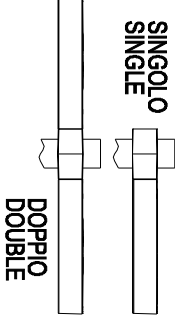
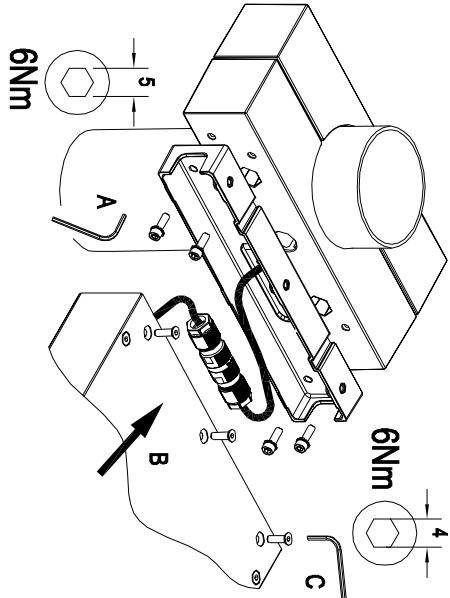
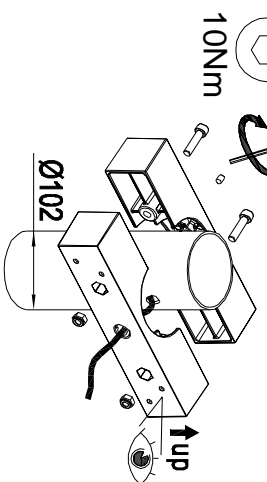
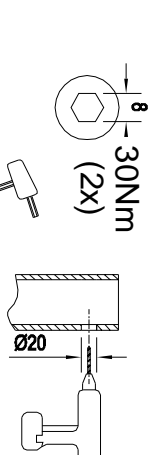
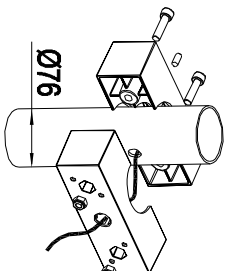

2.5-4-5-8

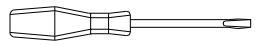

06L.T903C0 / 06L.T904C0 -

4. Installazione - installation:

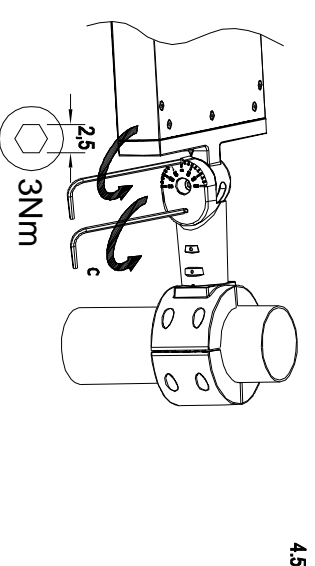
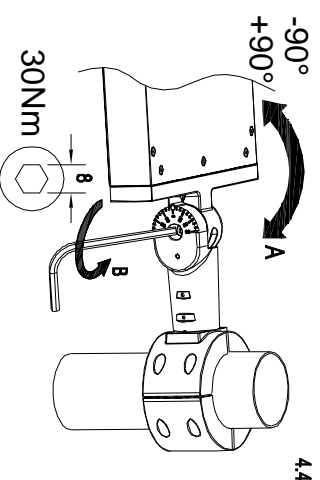
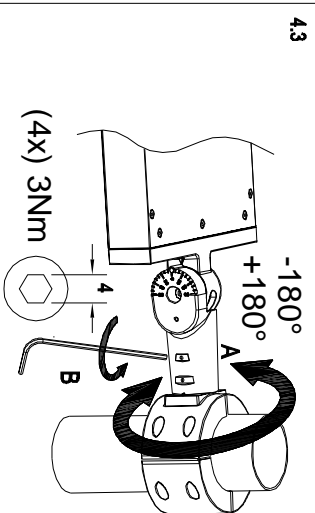
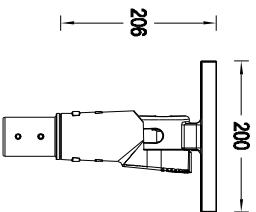
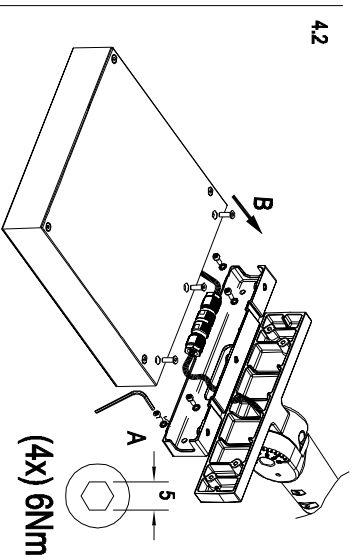
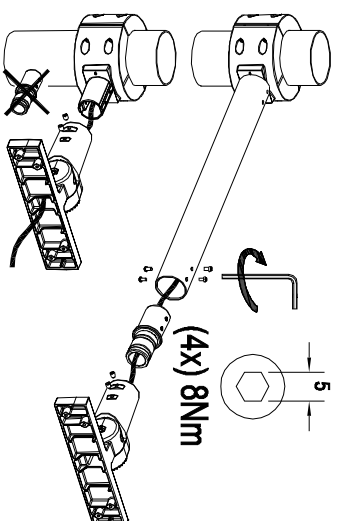
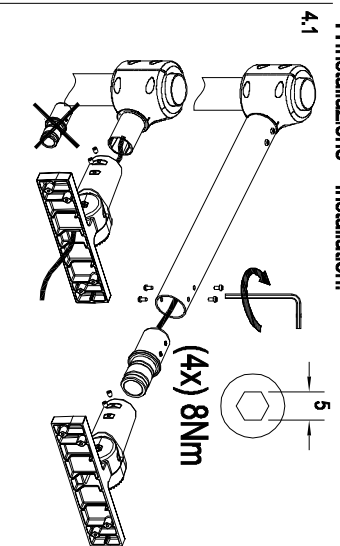
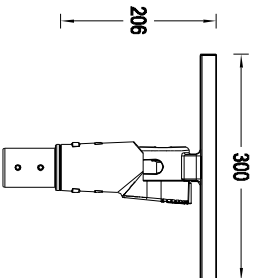

06L.T908C0 -

5. Installazione - installation:

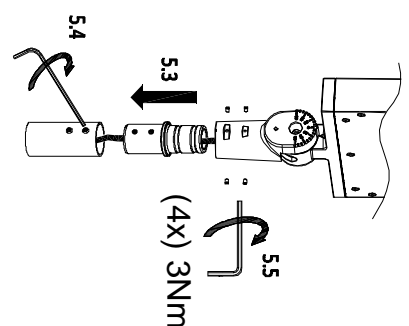
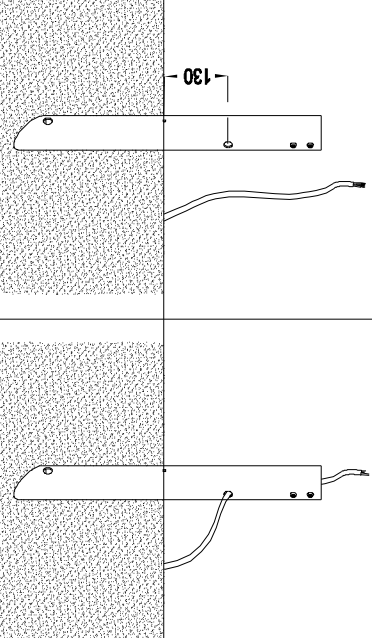

IT

L'installazione necessita l'intervento di personale specializzato. La sorgente luminosa contenuta in questo apparecchio deve essere sostituita solo dal costruttore o dal suo servizio di assistenza o da personale altrettanto qualificato. ATTENZIONE! PERICOLO DI SCOSSA ELETTRICA. PRIMA DI EFFETTUARE OPERAZIONI DI MONTAGGIO O MANUTENZIONE TOGLIERE LA TENSIONE. In caso di rottura del vetro, l'apparecchio deve essere riparato esclusivamente dal costruttore. Conservare l'etichetta d'obbligo per l'identificazione dell'apparecchio in caso di incendio. Nel caso di installazione su pali in vetroresina verificare la rispondenza a quanto indicato sul sito internet <http://www.carbonigroup.com/download/informazioni-tecniche>. L'apparecchio di illuminazione dovrebbe essere posizionato in modo che non sia prevista un'osservazione prolungata dell'apparecchio a una distanza inferiore a 3,7m (LT L); 2.6m (LT M); 2m (LT S) (IEC/TR 62776:2014). Adatto al funzionamento in interni. Altezza di installazione universale.

EN

The installation must be carried out by qualified technicians. The light source contained in this luminaire shall only be replaced by the manufacturer or his service agent or a similar qualified person. WARNING! DANGER OF ELECTRIC SHOCK. DISCONNECT FROM ELECTRICAL SUPPLY DURING INSTALLATION OR MAINTENANCE. In case of glass fracture, the appliance should be serviced only by the manufacturer. Keep packing label to identify fitting. In case of claim. In case of installation on fiberglass posts, please check compliance to instructions on website <http://www.carbonigroup.com/download/technical-information>. The luminaire should be positioned so that prolonged staring into the luminaire at a distance closer than a 3.7m (LT L); 2.6m (LT M); 2m (LT S) is not expected (IEC/TR 62776:2014). Suitable for indoor installation. Universal installation height.