

NEKO / MIU

Ceiling Mounted and Pendant Light



**MIU** Series  
Ceiling Mounted and Pendant Light



MIU-C S



MIU-C M



MIU-C L



MIU-P S



MIU-P M



MIU-P L

**NEKO / MIU**  
Ceiling Mounted Light



**MIU-CL**

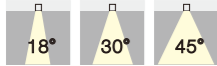

**MIU-C M**

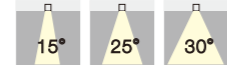

**MIU-C S**

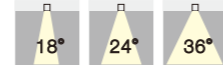

Spot, narrow and medium beam angles are available for different lighting applications

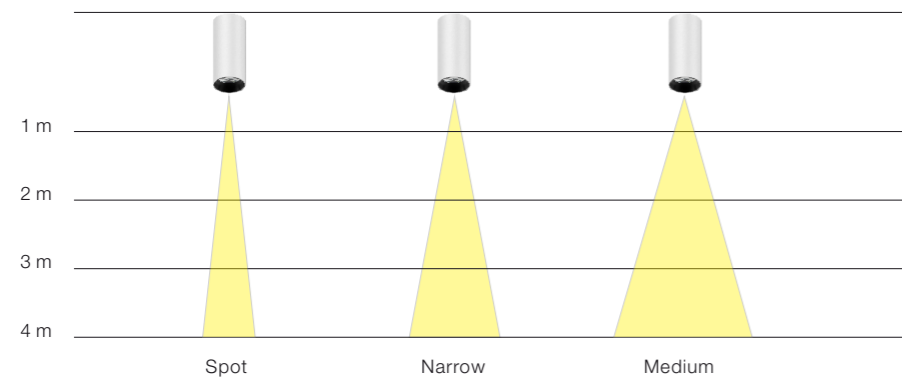

**NEKO / MIU / MIU-C S**  
Ceiling Mounted Light



11W	CR183 CRI90	2700K 3000K 4000K	680lm 720lm 800lm	18°	24°	36°
<b>CITIZEN</b> 50,000h@L80	<b>IP20</b>	<b>UGR</b> < 19	<b>5</b> GUARANTEED	<b>CB</b>	<b>CE</b>	

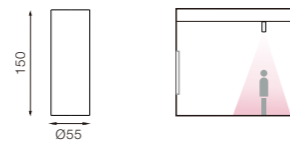

**Kurze Info**

- Schönes Gehäusedesign mit integriertem LED-Treiber
- Beste Lichtatmosphäre für angenehmen und blendfreien Sehkomfort
- Design mit Twist-Lock-Mechanismus, einfache installation

**Short Info**

- Ultra-slim housing design with internal LED driver
- Excellent optical performance with maximum eye comfort
- Twist-lock mechanism design, simple installation

**Features**

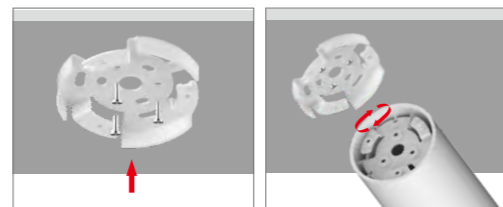

- Ceiling installation plate fixed by screws
- Twist and lock system between housing and ceiling installation plate

**Order Information**

**MIU-C S-11W**

CITIZEN LED powered by 260mA constant current internal LED driver, White housing

Model	LED Power	System Power	LED Voltage	LED Current	CRI	CCT	BEAM	LED output	System output	Code
MIU-C S-11W-930-18D	9 W	11 W	36 V	260 mA	90	3000K	18°	950 lm	720 lm	L2001C7W(X)
MIU-C S-11W-940-18D	9 W	11 W	36 V	260 mA	90	4000K	18°	1050 lm	800 lm	L2001C8W(X)
MIU-C S-11W-930-24D	9 W	11 W	36 V	260 mA	90	3000K	24°	950 lm	720 lm	L2001G7W(X)
MIU-C S-11W-940-24D	9 W	11 W	36 V	260 mA	90	4000K	24°	1050 lm	800 lm	L2001G8W(X)
MIU-C S-11W-930-36D	9 W	11 W	36 V	260 mA	90	3000K	36°	950 lm	720 lm	L200137W(X)
MIU-C S-11W-940-36D	9 W	11 W	36 V	260 mA	90	4000K	36°	1050 lm	800 lm	L200138W(X)

Remark: X= F(ON-OFF)

**Version**



**Optional accessory**

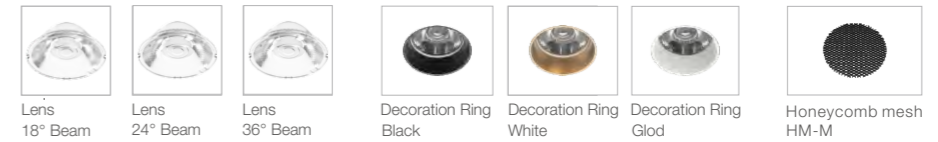

**Light Distribution**

**3000K**

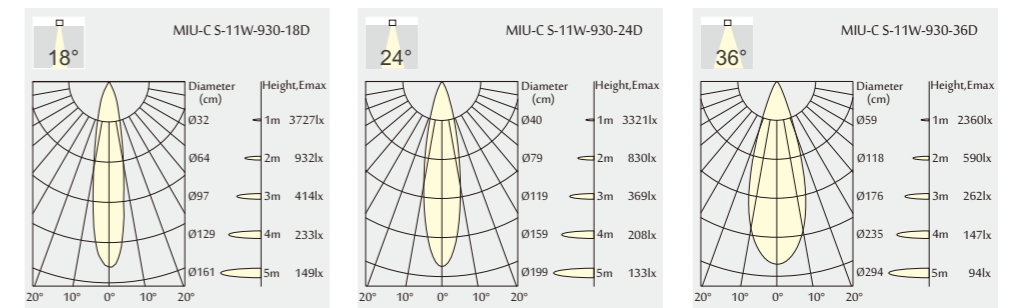

For more info see: [www.nekolighting.com](http://www.nekolighting.com)

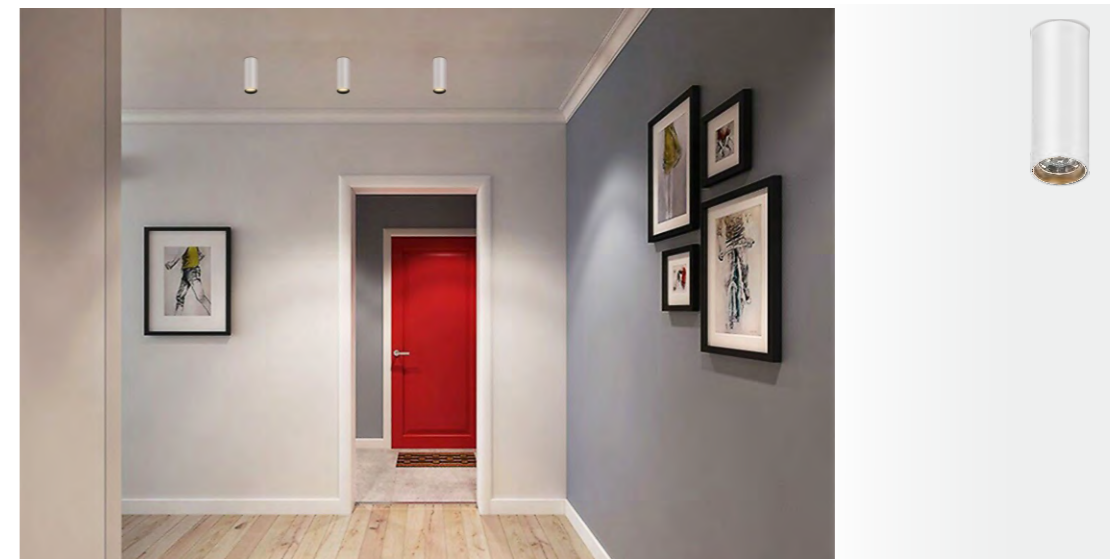

**NEKO / MIU / MIU-C M**  
Ceiling Mounted Light



21W 15W	CR183 CRI90	2700K 3000K 4000K	1500lm 1600lm 1700lm	15°	25°	30°

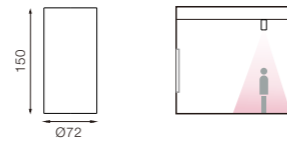

**Kurze Info**

- Schönes Gehäusedesign mit integriertem LED-Treiber
- Beste Lichtatmosphäre für angenehmen und blendfreien Sehkomfort
- Design mit Twist-Lock-Mechanismus, einfache installation

**Short Info**

- Elegant housing design with internal LED driver
- Excellent optical performance with maximum eye comfort
- Twist-lock mechanism design, simple installation

**Features**

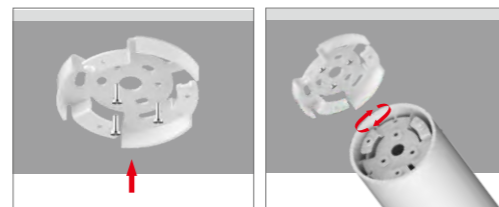

- Ceiling installation plate fixed by screws
- Twist and lock system between housing and ceiling installation plate

**Order Information**

**MIU-C M-15W**

CITIZEN LED powered by 350mA constant current internal LED driver, White housing

Model	LED Power	System Power	LED Voltage	LED Current	CRI	CCT	BEAM	LED output	System output	Code
MIU-C M-15W-930-15D	13 W	15 W	36 V	350 mA	90	3000K	15°	1500 lm	1200 lm	L2011B7W(X)
MIU-C M-15W-940-15D	13 W	15 W	36 V	350 mA	90	4000K	15°	1600 lm	1300 lm	L2011B8W(X)
MIU-C M-15W-930-25D	13 W	15 W	36 V	350 mA	90	3000K	25°	1500 lm	1200 lm	L2011D7W(X)
MIU-C M-15W-940-25D	13 W	15 W	36 V	350 mA	90	4000K	25°	1600 lm	1300 lm	L2011D8W(X)
MIU-C M-15W-930-30D	13 W	15 W	36 V	350 mA	90	3000K	30°	1500 lm	1200 lm	L201127W(X)
MIU-C M-15W-940-30D	13 W	15 W	36 V	350 mA	90	4000K	30°	1600 lm	1300 lm	L201128W(X)

**MIU-C M-21W**

CITIZEN LED powered by 500mA constant current internal LED driver, White housing

Model	LED Power	System Power	LED Voltage	LED Current	CRI	CCT	BEAM	LED output	System output	Code
MIU-C M-21W-930-15D	18 W	21 W	36 V	500 mA	90	3000K	15°	2000 lm	1600 lm	L2012B7W(X)
MIU-C M-21W-940-15D	18 W	21 W	36 V	500 mA	90	4000K	15°	2100 lm	1700 lm	L2012B8W(X)
MIU-C M-21W-930-25D	18 W	21 W	36 V	500 mA	90	3000K	25°	2000 lm	1600 lm	L2012D7W(X)
MIU-C M-21W-940-25D	18 W	21 W	36 V	500 mA	90	4000K	25°	2100 lm	1700 lm	L2012D8W(X)
MIU-C M-21W-930-30D	18 W	21 W	36 V	500 mA	90	3000K	30°	2000 lm	1600 lm	L201227W(X)
MIU-C M-21W-940-30D	18 W	21 W	36 V	500 mA	90	4000K	30°	2100 lm	1700 lm	L201228W(X)

Remark: X= F (ON-OFF)

**Version**



Black

White

**Optional accessory**

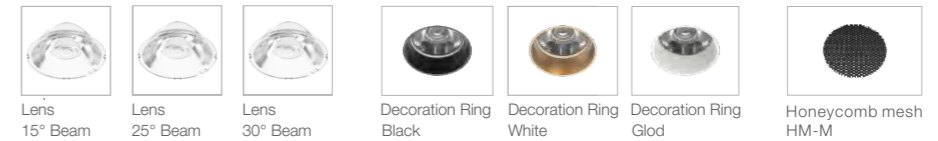

Lens  
15° Beam

Lens  
25° Beam

Lens  
30° Beam

Decoration Ring  
Black

Decoration Ring  
White

Decoration Ring  
Glod

Honeycomb mesh  
HM-M

**Light Distribution**

3000K

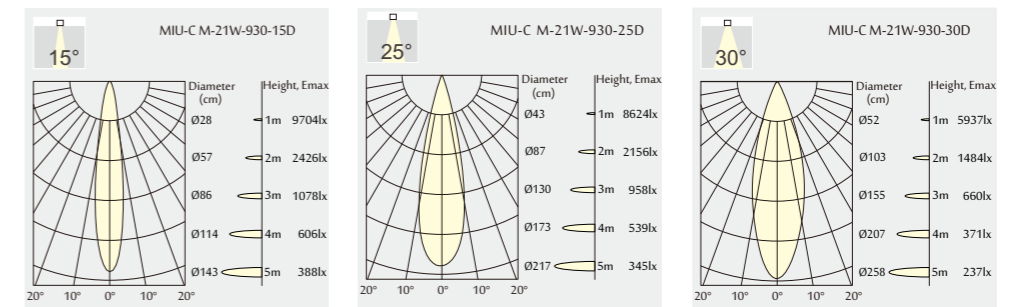

**NEKO / MIU / MIU-C L**  
Ceiling Mounted Light



28W	CR183 CRI90	2700K 3000K 4000K	2500lm 2700lm 2900lm	18°	30°	45°
<b>CITIZEN</b> 50,000h@L80	IP20	UGR < 19	5 YEAR WARRANTY	<b>CB</b>	<b>CE</b>	

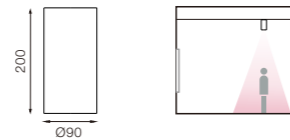

**Kurze Info**

- Funktionales Gehäusedesign mit integriertem LED-Treiber
- Beste Lichtatmosphäre für angenehmen und blendfreien Sehkomfort
- Design mit Twist-Lock-Mechanismus, einfache installation

**Short Info**

- Functional housing design with internal LED driver
- Excellent optical performance with maximum eye comfort
- Twist-lock mechanism design, simple installation

**Features**

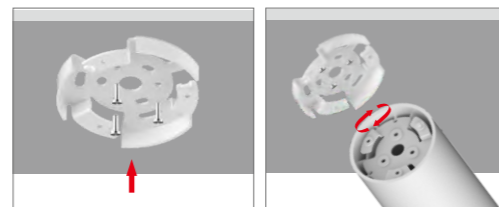

- Ceiling installation plate fixed by screws
- Twist and lock system between housing and ceiling installation plate

**Order Information**

**MIU-C L-28W**

CITIZEN LED powered by 700mA constant current internal LED driver, White housing

Model	LED Power	System Power	LED Voltage	LED Current	CRI	CCT	BEAM	LED output	System output	Code
MIU-C L-28W-930-18D	25 W	28 W	36 V	700 mA	90	3000K	18°	3400 lm	2700 lm	L2021C7W(X)
MIU-C L-28W-940-18D	25 W	28 W	36 V	700 mA	90	4000K	18°	3600 lm	2900 lm	L2021C8W(X)
MIU-C L-28W-930-30D	25 W	28 W	36 V	700 mA	90	3000K	30°	3400 lm	2700 lm	L202127W(X)
MIU-C L-28W-940-30D	25 W	28 W	36 V	700 mA	90	4000K	30°	3600 lm	2900 lm	L202128W(X)
MIU-C L-28W-930-45D	25 W	28 W	36 V	700 mA	90	3000K	45°	3400 lm	2700 lm	L202177W(X)
MIU-C L-28W-940-45D	25 W	28 W	36 V	700 mA	90	4000K	45°	3600 lm	2900 lm	L202178W(X)

Remark: X= F(ON-OFF)

**Version**



**Optional accessory**

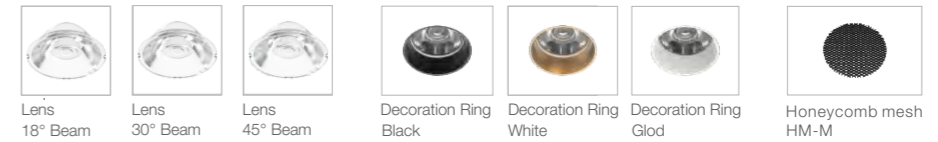

**Light Distribution**

**3000K**

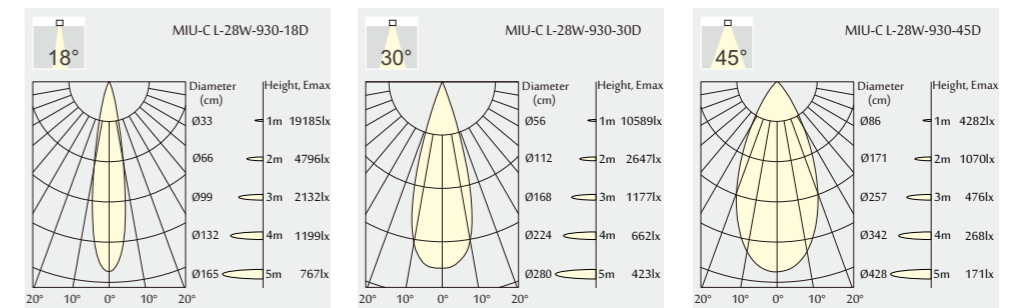

For more info see: [www.nekolighting.com](http://www.nekolighting.com)

